

Thinking of you

 **Electrolux**



cycloneXL

XLarge Capacity for XLong Performance

EN Operating Instructions



Thank you for having chosen an Electrolux CycloneXL vacuum cleaner. These Operating Instructions cover all CycloneXL models. This means that with your specific model, some accessories/features may not be included. In order to ensure the best results, always use original Electrolux accessories. They have been designed especially for your vacuum cleaner.

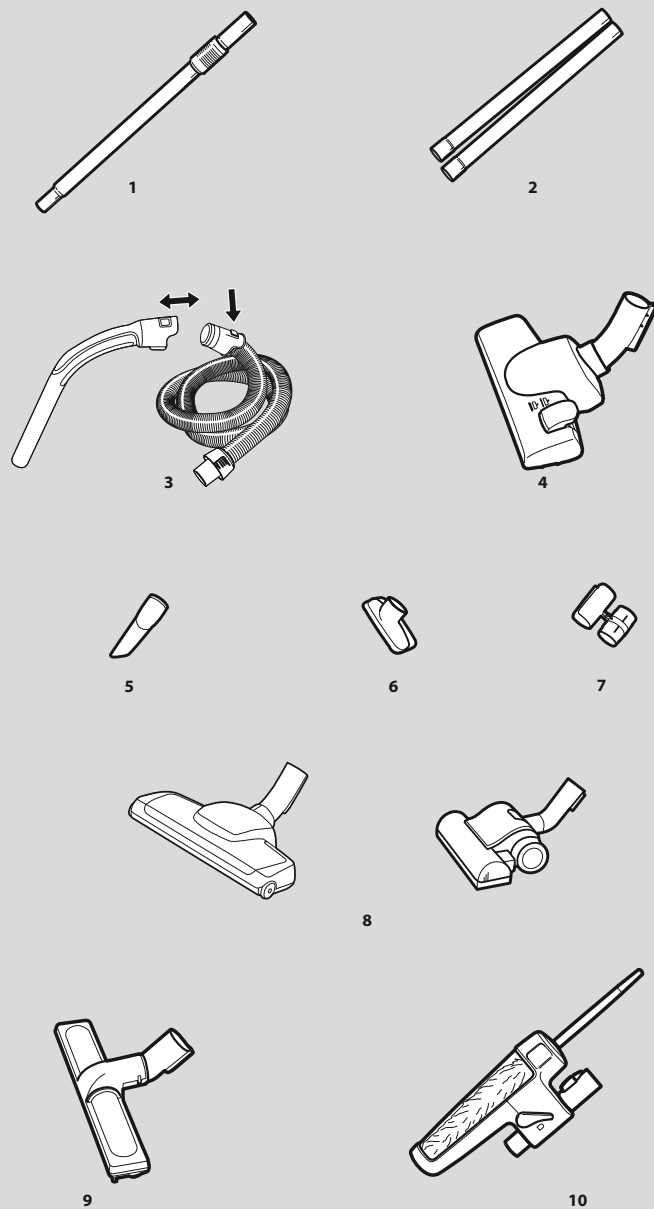

Accessories

- | | |
|----------------------------|--------------------|
| 1* Telescopic tube | 7 Accessories clip |
| 2* Extension tubes | 8* Turbo nozzle |
| 3 Hose handle + hose | 9* Parquet nozzle |
| 4 Combination floor nozzle | 10* Feather duster |
| 5 Crevice nozzle | |
| 6 Upholstery nozzle | |

Safety precautions

CycloneXL should only be used by adults and only for normal vacuuming in a domestic environment. The vacuum cleaner features double insulation and does not need to be earthed. Disconnect the plug from the mains before cleaning or maintenance of the vacuum cleaner. Be sure to keep the vacuum cleaner in a dry place. All servicing and repairs must be carried out by an authorised Electrolux service centre.

Never vacuum:

- In wet areas.
- Close to flammable gases etc.
- When housing shows visible signs of damage.

Never vacuum:

- Sharp objects, fluids.
- Hot or cold cinders, lit cigarette butts, etc.
- Fine dust, for example from plaster, concrete, flour, hot or cold ashes.

The above may cause serious damage to the motor – damage which is not covered by the warranty.

Electrical cable precautions:

Regularly check that the cable is not damaged. Never use the vacuum cleaner if the cable is damaged. Damage to the machine's cable is not covered by the warranty.

Before starting

- 11 Open the front cover on the machine and check that the motor filter and the dust container filter are in place. (See also Cleaning/replacing the filters.)
- 12* Open the back lid on the machine and check that the exhaust filter is in place.
- 13 Insert the hose until the catches click to engage (press the catches to release the hose).
- 3 Insert the hose into the hose handle until the catches click to engage (press the catches to release the hose).
- 14 Attach the extension tubes* or telescopic tube* to the hose handle and nozzle by pushing and twisting together. (Twist and pull apart to dismantle.)
- 15 Extend the electric cable and connect it to the mains. The vacuum cleaner is fitted with a cable winder. Once the electric cable has been extended, it stays in that position.
- 16 To rewind the cable, press the cord rewinder pedal. The cable will then rewind.
- 17a Start the vacuum cleaner by rotating the power control in the direction of the "Max" position. Increase suction power by rotating the control further up to "Max" position. Stop the vacuum cleaner by rotating in the opposite direction to "Off" position.

In order to achieve an optimal cyclone effect in the cleaner, the power regulation should always be in the "Max" position.

- 17b* Suction power can also be adjusted by using the suction control on the hose handle.
- 18 Ideal parking position for pausing (18a) and storing (18b).

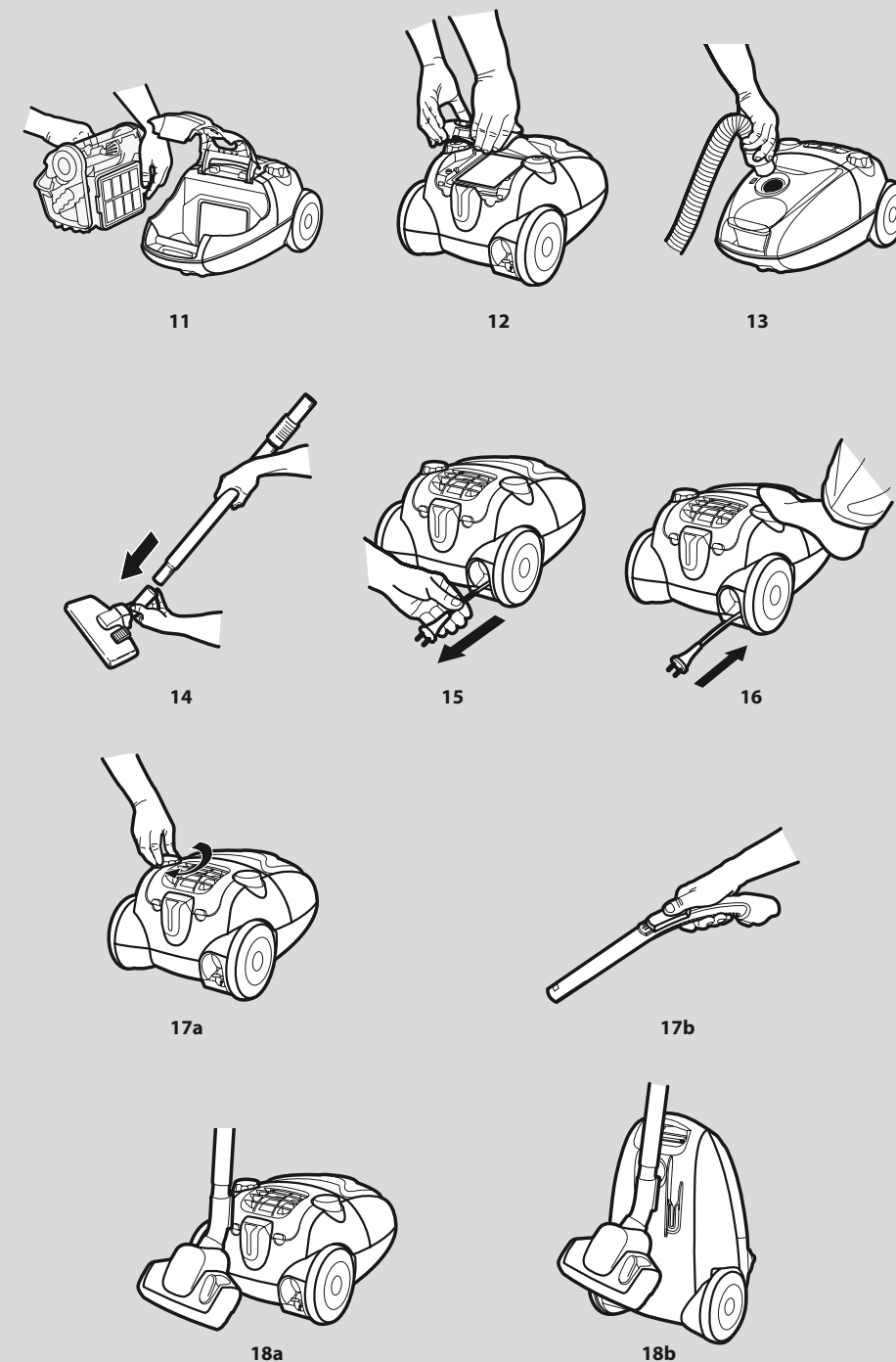

* Certain models only.

* Certain models only.

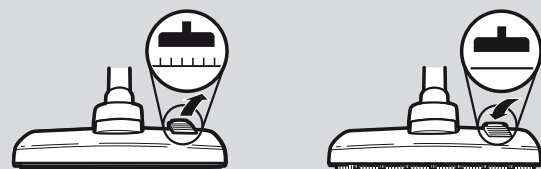

19

20



21



22

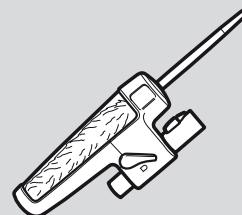

23



24

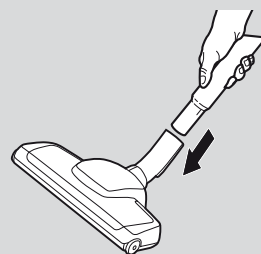

25

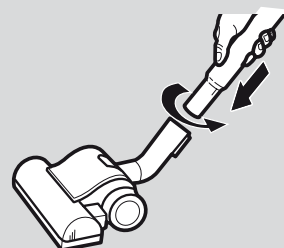

26

Getting the best results

Use the nozzles as follows:

Carpets: Use the combination floor nozzle with the lever in position (19).

Hard floors: Use the combination floor nozzle with the lever in position (20).

Wooden floors: Use the parquet nozzle* (21).

Upholstered furniture and fabrics: Use the upholstery nozzle* (22) for sofas, curtains, lightweight fabrics etc. Reduce suction power if necessary.

Frames, bookshelves, etc.: Use the feather duster* (23).

Crevices, corners, etc.: Use the crevice nozzle* (24).

Using the turbo nozzle*

25/26 Ideal for carpets and wall-to-wall carpeting to remove stubborn fluff and pet hairs.

Note: Do not use the turbo nozzle on skin rugs or carpet fringes. To avoid damaging the carpet, do not keep the nozzle stationary whilst the brush is rotating. Do not pass the nozzle across electric cables, and be sure to switch off the vacuum cleaner immediately after use.

* Certain models only.

Emptying and cleaning the dust container

CycloneXL's dust container must be emptied when it is full.

- 27 Pull the release button at the rear of the vacuum cleaner.
- 28 Lift the dust container out.
- 29 Open the lid of the dust container by pressing the release button on the right.
- 30 Empty it over a wastepaper basket. Put the dust container back (31) and press the rear part of the container until it clicks into place.
- 32 Every now and then the dust container should be cleaned. Remove lids at both ends and rinse the container in water or machinewash it. Remove particles that may be stuck in the cone.

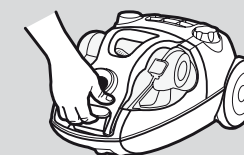

27

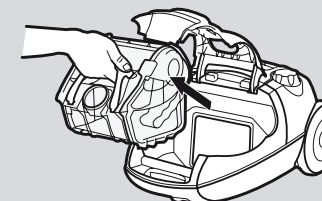

28

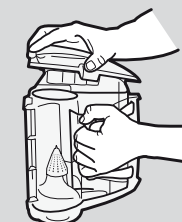

29



30

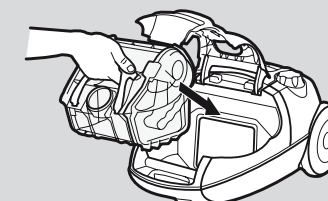

31

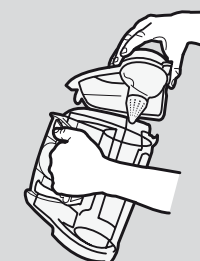

32

* Certain models only

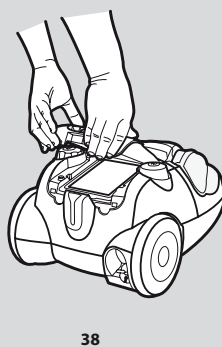
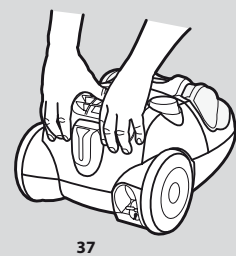
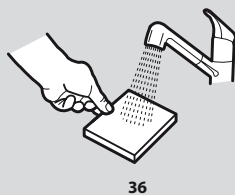
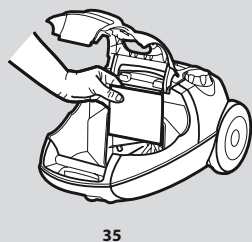
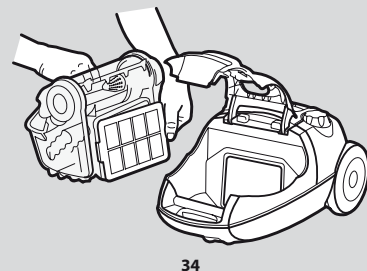
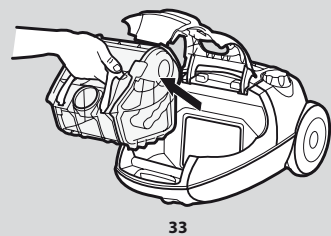

Cleaning the motor filter and the dust container filter

CycloneXL has a motor filter and a dust container filter that should be cleaned now and then.

- 33 Open the front lid and lift out the dust container.
- 34 Dust container filter: Remove the filter holder from the dust container and carefully pull the dirty dust container filter out of the holder.
- 35 Motor filter: Pull the filter upwards until coming away from the groove.
- 36 Rinse the filters in lukewarm water and let them dry. Reattach the clean filters. Replace the dust container and then close the lid.

Cleaning/replacing the exhaust filter*

There are three types of exhaust filter:

- Micro filter* (Ref. No. EF 17)
- Hepa H12* non washable (Ref. No. EF H12)
- Hepa H12* washable (can be bought as an option, Ref. No. EF H12W)

The filters must always be replaced with new ones and cannot be washed (except the Hepa H12* washable).

- 37 Open the back lid and lift out the filter.
- 38 Insert a new filter and close the lid.

* Certain models only.

Cleaning the hose and nozzle

The vacuum cleaner stops automatically if the nozzle, tube, hose or filters become blocked and when the dust container is full. In such cases, disconnect from mains and allow to cool for 20-30 minutes. Clear blockage and/or replace filters, empty the dust container and restart.

Tubes and hoses

- 39 Use a cleaning strip or similar to clear the tubes and hose.
- 40 Hose handle could be dismantled from hose if cleaning is needed.
- 41 It may also be possible to remove the obstruction in the hose by squeezing it. However, be careful in case the obstruction is caused by glass or needles caught inside the hose.

Note: The warranty does not cover any damage to the hose caused by cleaning it.

Cleaning the floor nozzle

- 42 Be sure to frequently clean the combination floor nozzle.
- 43* Press each wheel-hub and draw away the wheels. Remove dust-balls, hair or other objects that may be entangled.
- 44* Larger objects can be accessed by removing the connection tube from the nozzle.

Cleaning the turbo nozzle*

- 45 Disconnect the nozzle from the vacuum cleaner tube and remove entangled threads, etc. by snipping them away with scissors. Use the hose handle to clean the nozzle.
- 46a Disconnect the nozzle from the vacuum cleaner tube and remove entangled threads, etc. by snipping them away with scissors. Use the hose handle to clean the nozzle.
- 46b In case the turbo nozzle stops working, open the cleaning lid and remove any objects that obstructs the turbine to rotate freely.

* Certain models only.

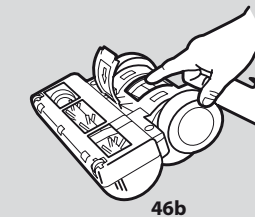
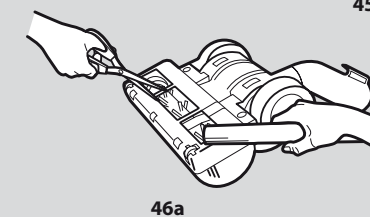
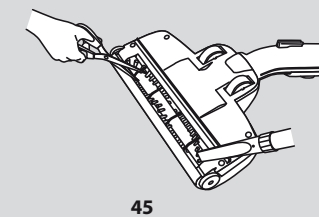
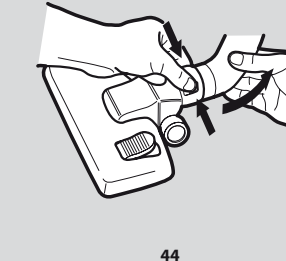
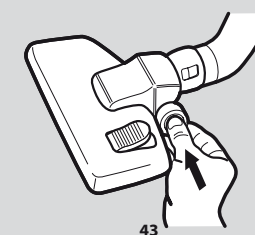
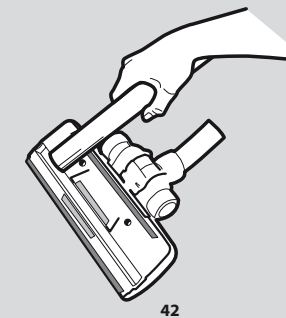
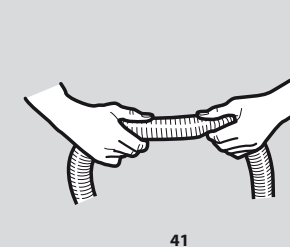
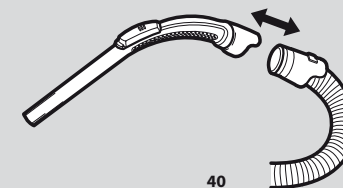
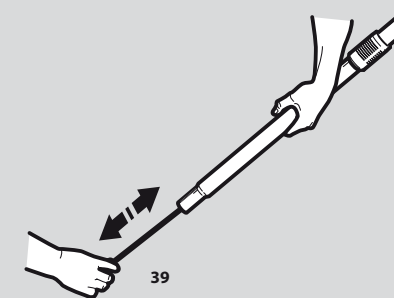

Troubleshooting

- Check that the cable is connected to the mains.
- Check that the plug and cable are not damaged.
- Check for a blown fuse.

The vacuum cleaner stops

- Check whether the dust container is full. If so, empty it.
- Is the nozzle, tube or hose blocked?
- Are the filters blocked?

Water has entered the vacuum cleaner

It will be necessary to replace the motor at an authorised Electrolux service centre. Damage to the motor caused by the penetration of water is not covered by the warranty.

Consumer information

Electrolux decline all responsibility for all damages arising from any improper use of the appliance or in cases of tampering with the appliance. This product is designed with the environment in mind. All plastic parts are marked for recycling purposes. For details see our web site: www.electroluc.com

If the supply cord is damaged, it must be replaced by the manufacturer, its service agent or similarly qualified person in order to avoid a hazard.

Young children should be supervised to ensure that they do not play with the appliance. Close attention is necessary when used near children.
The appliance is not intended for use by young children and infirm persons without supervision.



The symbol  on the product or on its packaging indicates that this product may not be treated as household waste. Instead it shall be handed over to the applicable collection point for the recycling of electrical and electronic equipment. By ensuring this product is disposed of correctly, you will help prevent potential negative consequences for the environment and human health, which could otherwise be caused by inappropriate waste handling of this product. For more detailed information about recycling of this product, please contact your local city office, your household waste disposal service or the shop where you purchased the product.

